

# The BackBulb

C A R M E L O R C H I D S O C I E T Y

October 2013



## October Speaker: Paul Gripp

On October 7, 2013, Paul Gripp of the Santa Barbara Orchid Estates "will be in the house" speaking and teaching at the COS regularly scheduled monthly meeting. For

those of you who are not in the know, Paul is one of the "living legend" orchid growers. If you go to the Santa Barbara Orchid Estates web site [www.sborchid.com](http://www.sborchid.com) and check out the About SBOE tab, you'll learn that Paul takes second fiddle to SBOE's founder Robert J. Chrisman. Truth be told, he is not a second fiddle in the orchid world. His knowledge about orchids and ability to nudge great blooms out of even the most difficult of those prima donna darlings is more than enviable, it is treasure which we will be able to tap.

Paul is not a "scripted" kind of speaker. He arrives with a slew of medium to huge blooming orchids and tells us about them. No wondering if the power point pictures do the plant justice. If late summer/fall blooming Brazilian orchids are still showing their colors, they will be the focus of his talk; cool growing Laelia's perhaps? If they have spent their glory, Paul will surprise us with

This month's meeting is on **Monday October 7th, 7PM** at the Community Church of Monterey Peninsula. 4590 Carmel Valley Rd.

**1**  
October Meeting

**2**  
Fall Orchid Festival  
Volunteers & Notes  
Upcoming Events

**3**  
Sell Your Orchids At  
the Show

**4**  
Show Off Your  
Orchids

**6**  
September Board  
Meeting Minutes



whatever is in blooming at the Estates. This is not a talk to miss - nor is the opportunity table he will be bringing (winning raffle tickets will get you a choice Santa Barbara Estates plant).

In order to provide a selection of treats at our meetings, we are asking members with last names that start with the letter **M thru R** to **bring refreshments** to the next meeting.

## COS Officers

**President/BackBulb**

**Editor/Webmaster**

John OConnell

**VP Program**

Kathie Ritter

**Recording**

**Secretary**

Janette Ford

**Treasurer**

Daniel Bellem

**Directors**

Carol Easton

Lesley Olsen

Jeanette Brown

Lory Schlunz

P.O. Box 223462

Carmel

CA 93922-3462

## Fall Orchid Festival Volunteers:

There will sign up sheets at the October meeting for volunteers for Set Up Friday afternoon, Member Sales for Friday afternoon & Saturday, set up of Orchid Display Friday afternoon, Silent Auction Friday afternoon & Saturday day, & tear down Saturday after 4 PM and food for lunch for vendors & volunteers. Please come to the meeting to sign up and if you can't, **call Evelyn Anzini 625-2445.**

## Other Show Notes:

Please watch your orchid collections carefully during the next month to see which ones may be blooming for November 9. Please bring a list of the possible blooming orchids to the next meeting. We need this to determine the size of the display.



Members are being asked to bring either sandwiches, salads or desserts for lunch on Saturday for the vendors and volunteers. Sign up sheets will be available.

## Upcoming Events

### October

10/7 Monday COS October Meeting. Speaker: Paul Grip

### November

**11/4 Monday COS November Meeting**

**11/9 COS Fall Orchid Festival**

## Sell Your Orchids at the Fall Show

If your orchid garden or greenhouse is overflowing, dividing and/or selling some of your plants at the fall show is a good way to make room for more orchids! Or if others have envied some of your plants at "show and tell" maybe you could make a little money by dividing that specimen. Members (only members please) of COS are encouraged to bring plants from their collections to sell. Here are a few guidelines for sales:

1. Plants should be disease and pest free.
2. Fill out a sales tag (they are included with this newsletter) as completely as possible. Plants that have a picture attached and have as much information about the plant as possible sell better. Attach the tag to your plant securely with masking tape or on a stick. If you have several plants, it is always a good idea for you to keep a list of the names and prices of the plants you bring.
3. COS will keep 25% of each sale as a part of our fundraiser. Price your plants accordingly, but remember that affordable plants sell first. Volunteers who will be at the sales table will not change prices on your plants, so if your plant is not selling, you may want to stop by the table during the show to change the price.
4. Plants can be brought to the church (show location) on Friday afternoon, Nov. 8. If you cannot bring them

until Saturday, we will set them out for sale in order as they are received. You will need to pick up any unsold plants at 4:00 on Saturday.

I look forward to finding some real gems to purchase (don't tell my husband) among the member's orchids!

**Janette Ford, Member's sales chair**



Bought at member sales or ready to be sold at member sales?



## Show Off Your Orchids!

One of the major attractions at the Carmel Orchid Society Show and Sale has always been the members display. As usual this year we will have a special display of many varieties of blooming orchids at the Community Church of the Monterey Peninsula where we have our meetings. In order to create the splendor of orchids for which the Carmel Orchid Society is famous, we need your contributions!

The display will be assembled on Friday afternoon in the Hall where we have our meetings. Plants should be brought to the Hall after noon on November 8th . The show opens at 9am on Saturday morning, and the display must be in place.

Members are requested to bring their plants in an attractive container or basket. The plants must have the leaves cleaned and free of pests as the volunteers will not be able to do this. The Society volunteers will place a sign on the plant stating its name, lineage,

etc. If you cannot bring the plants in yourself, please contact Carol Easton at 595-5254 and we will try to arrange a pickup. Last minute additions may be accepted before 9am on Saturday if space is available.

At the conclusion of the show the display will be disassembled and the plants will be available from where the Display Area tables were located during the show. No plants are available until 4:15 pm on Saturday, November 9 .

The Guidelines that have been adopted for the Carmel Orchid Society Fall Orchid Festival include:

1. All plants are pest and disease free.
2. The leaves are clean and attractive.
3. Plant is blooming to display its special attributes.
4. Pot is provided with an outer container.
5. Plants must be staked and secured appropriately.

Members must pick up their plants promptly at 4:15pm on Saturday,

November 9th. We must be out of the Hall early Saturday evening. Nothing can be left at the Church. We urge you to come a little early to help us by assisting with clean up. . Many hands make light work for all! See you there!



2011's CVGS display

# BackBulb CARMEL ORCHID SOCIETY

tape to plant	COS Plant Sale Tag	Price _____ plant id _____	Price _____
	Plant Name _____	plant id _____	plant id _____
	Culture/Comments _____	Sellers name _____	Sellers name _____
	Sellers Name _____	_____	_____
tape to plant	COS Plant Sale Tag	Price _____ plant id _____	Price _____
	Plant Name _____	plant id _____	plant id _____
	Culture/Comments _____	Sellers name _____	Sellers name _____
	Sellers Name _____	_____	_____
tape to plant	COS Plant Sale Tag	Price _____ plant id _____	Price _____
	Plant Name _____	plant id _____	plant id _____
	Culture/Comments _____	Sellers name _____	Sellers name _____
	Sellers Name _____	_____	_____
tape to plant	COS Plant Sale Tag	Price _____ plant id _____	Price _____
	Plant Name _____	plant id _____	plant id _____
	Culture/Comments _____	Sellers name _____	Sellers name _____
	Sellers Name _____	_____	_____
tape to plant	COS Plant Sale Tag	Price _____ plant id _____	Price _____
	Plant Name _____	plant id _____	plant id _____
	Culture/Comments _____	Sellers name _____	Sellers name _____
	Sellers Name _____	_____	_____
tape to plant	COS Plant Sale Tag	Price _____ plant id _____	Price _____
	Plant Name _____	plant id _____	plant id _____
	Culture/Comments _____	Sellers name _____	Sellers name _____
	Sellers Name _____	_____	_____

Print this page for your CVGS member plant sales tags. Fill out 1 tag per plant and attach to the plant. Use the "plant id" field to give each plant a unique code, so you know what you sold.

## **COS Board of Directors Meeting**

**September 16, 2013**

**Members Present:** John O'Connell, Kathie Ritter, Janette Ford, Daniel Bellem, Carol Easton, Lory Schluenz, Jeannette Brown. Meeting called to order at 7:25 p.m. at John's house.

**Previous Minutes:** Minutes from the August meeting were approved by acclamation.

**Treasurer's Report:** Balance at the beginning of August was \$8594.70; at the end of the month balance was \$8533.10.

**Board Slate for 2014:** John had suggested at the August meeting that he and Kathie switch offices. The consensus of the board was to make that switch for the board slate. Daniel offered to remain as treasurer, Janette offered to remain as recording secretary, Carol offered to remain as membership chair, Lory and Jeannette offered to remain on the board as directors. We will check with Lesley to see if she wishes to remain on the board. It was recommended that we check with Francis Richardson to see if she would consider being on the board, and nominations will also be open before the vote is taken.

**Fall Show:** Carol has updated the project plan with "to do" lists for each project chair. So far, four orchid vendors have agreed to come, and one jewelry vendor is coming.

Logistics – Carol has located black aprons for tables. If Kathie can find some white tablecloths, we may use those.

Membership – It was agreed that we can just give out COS brochures rather than preparing manila envelopes with information sheets, etc.

Preparation for display, silent auction and member sales – Carol has arranged for us to be able to use the church Friday afternoon to set up, so all items to be displayed or sold can be brought in Friday afternoon. Lory said she would check IRS information to see if we need a letter from them before we can offer tax deductions for silent auction gifts.

Public relations – John designed, Carol and Daniel have ordered postcard size show information which will be available at the October COS meeting. They will order six banners to be placed at the following locations: each end of Laurles Grade, Costco, two for the church where show will be held, and one at a location on Rio Road. Daniel will check with proper authorities to get permission to hang the banners at each location. Carol and Kathie have made a list of places to contact about the show. Several places have already been notified. Carol plans to contact Kathy Nichols at the Herald to see if she will write an article about the show. Carol will check with the Carmel Pine Cone to see how much it would cost to place an ad about the show with them, and at least one of the online calendar sites has a fee.

# BackBulb C A R M E L O R C H I D S O C I E T Y

Next month we will review the budget and determine whether or not to place ads which require the fee.

**Next board meeting** will be at Kathie's house on Monday, Oct. 21.

Meeting adjourned at 9:30.

**Respectfully submitted, Janette Ford**

## C A R M E L O R C H I D S O C I E T Y 2013 Membership Application

Please make checks payable to the **Carmel Orchid Society** and mail to: Carmel Orchid Society - Membership c/o Carol Easton, P.O. Box 223462 Carmel CA 93922-3462

Please print

Date \_\_\_\_\_

Name \_\_\_\_\_

Address \_\_\_\_\_

City \_\_\_\_\_ State \_\_\_\_\_ zip \_\_\_\_\_

Telephone \_\_\_\_\_

Email address \_\_\_\_\_

If you were referred by a current member, please provide

his/her name \_\_\_\_\_

Renewal ☐ New Member ☐

Member of the American Orchid Society ☐

Membership Type	Receive Newsletter	
	Via E-Mail	Via US Mail
Single	\$20 <input type="checkbox"/>	\$25 <input type="checkbox"/>
Couple	\$30 <input type="checkbox"/>	\$35 <input type="checkbox"/>
Vendor	\$30 <input type="checkbox"/>	\$35 <input type="checkbox"/>





# Fall Orchid Festival

presented by the  
Carmel Orchid Society

**Saturday  
November  
9th  
9AM - 4PM**

**Orchid Sales  
Orchid Display  
Silent Auction  
Wine Barrel Raffle  
Orchid Care Classes  
Potting Demonstrations**

**Community  
Church of the  
Monterey  
Peninsula**

**4590 Carmel Valley Rd.  
Carmel CA**

**CarmelOrchidSociety.org**





## D & D Flowers

**Fall Open House  
October 12th & 13th, 2013  
9:00 AM to 3 PM**

**(D & D Flowers is not open to the public except for our bi-annual open house events)**

Really good deals... priced to sell. There is no list of plants available and divisions are sold on first come for serve. We will be having a \$7.00 sale on many cattleya, oncidium and cymbidium seedlings and back bulbs. We accept cash, checks, or credit cards.

Help your local orchid society. For every \$25 you spend, you may enter your local orchid society in a raffle for their monthly opportunity table. 30 healthy plants (some in bloom) will be award to the winning society. Winning society will be picked at the end of Sunday. The society must redeem their prize to D & D Flowers within 6 months of this sale. Spring winner is the Peninsula Orchid Society.

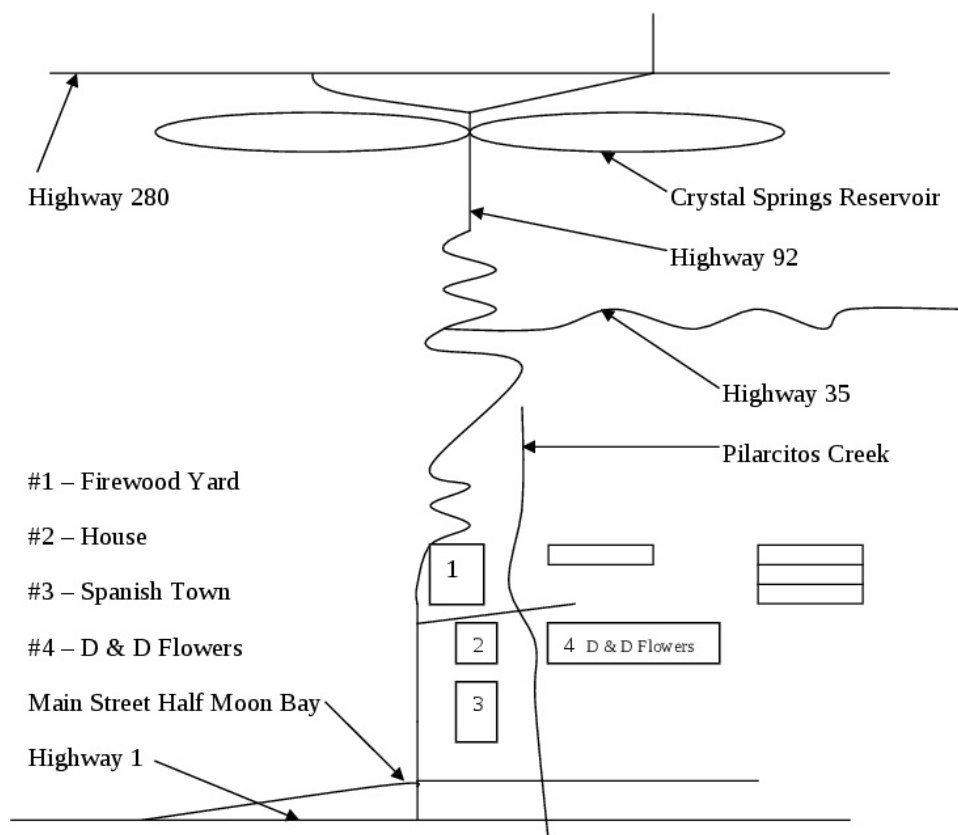

Half Moon Bay 1/3 mile east of Main Street off Hwy 92.

Just east of Spanish Town on Hwy. 92 there is a house and firewood business. Turn onto the street between the house and firewood business and go over the bridge into the greenhouse complex.

## **Peninsula Orchid Society 2013 Auction**

**Saturday afternoon, October 5th**

San Mateo Garden Center,  
605 Parkside Way,  
San Mateo, CA  
(Close to Hwy. 92)

**Auction begins at 1:30 PM**

Bidder registration and plant previewing begins at 12:00 PM

**EVERYONE WELCOME**

All plants will be from member's collections or donations from professional growers - we have both professional and hobby members. Come and find that special orchid!!

Cash, checks or credit cards accepted

We will post a list of pre-entries at <http://penorchidsoc.org/blogs/auction-2013/> starting about 2 weeks before the auction